

NORFAB 4' BADGER Extension Kit for the 8' x 8' Badger Shed Kit Materials Checklist

- 1 2 - 4' x 6' side wall extension panels, Hardboard
- 2 2 - 5" x 4' strips of plywood soffit
- 3 2 - 11½" x 4' sheets of 7/16" thick OSB Roofing material
- 4 2 - 4' x 4' sheets of 7/16" thick OSB Roofing material
- 5 2 - 2" x 3" x 48" Top plates
- 6 6 - 2" x 3" x 70" Wall studs
- 7 4 - 2" x 3" x 58" Rafter boards
- 8 2 - 2" x 3" x 48" side Fascia boards
- 9 4 - Gussets

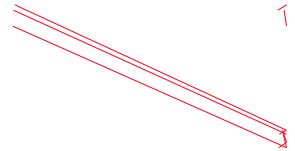
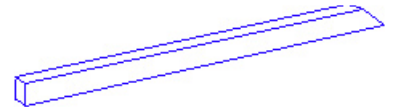
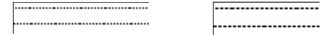
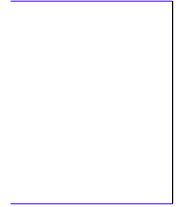

In order to incorporate this extension kit with the 8' x 8' Badger Lawn and Garden Shed, replace the following seven steps with their corresponding steps found in the instruction manual provided with the 8' x 8' Badger shed.

Customer Service Hotline 1-800-465-2918
NORFAB 4' Badger Extension Package

See separate Floor Instructions (Actual floor size is 8' wide x 11' 8 1/4" long)

STEP 4b:

Lay out both two-piece top wall plates which consist of a 2"x 3"x 92 1/4" from the 8' x 8' shed package and a 2"x 3"x 48" from this 4' extension kit. Measure 46 1/8" in from the end of the 92 1/4" top plate to mark the center point. Then measure 24" out from this point to mark the other two stud locations. On the 48" extension plate, mark 2" from its end to find the center point of the second extension wall stud and 24" from this point to mark the last stud location.

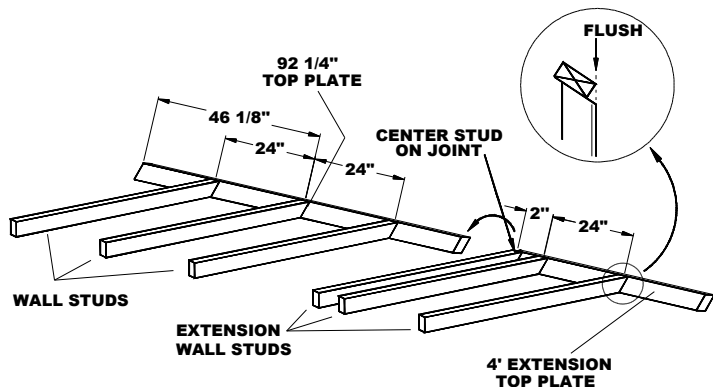

Install eight wall studs to the top wall plates, five from the 8' x 8' shed package and three from this 4' extension kit. Use the 3" nails provided to attach the plate to the studs, centered on your marks. As shown above, be certain to nail studs flush with the outside of the top plate. Please note that the first extension wall stud must be centered on the joint between the two top wall plates to bind this joint together.

STEP 5b:

Stand the stud and plate assemblies up on the inside of each upright wall half so that the splice in the top plate is nearest to the rear wall. Space the studs and plate assemblies 1 1/2" up from the bottom of the side panelling or rest and secure using 3" nails on top of the floor if applicable. Note: When no floor has been purchased, place the five wall studs on a level surface whether it is a concrete slab or cement blocks or any other floor of your choice. Be certain to overhang the wall panelling over your floor of choice as it is the wall studs that must support the shed, not the panelling.

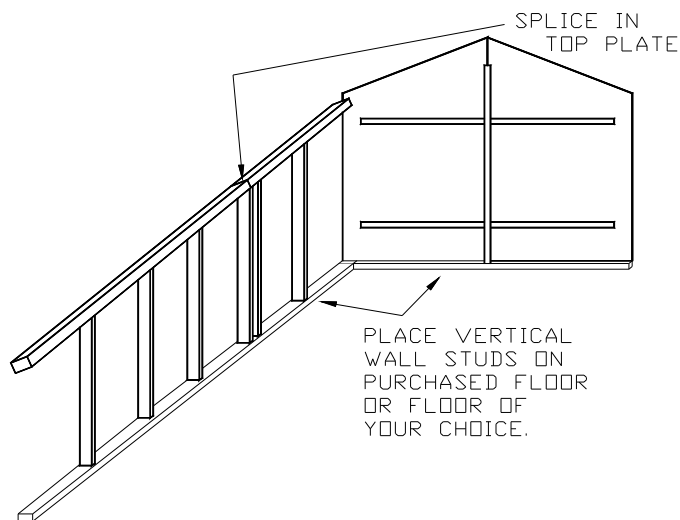

Customer Service Hotline 1-800-465-2918
NORFAB 4' Badger Extension Package

BASE PLATES SHOWN ARE NOT INCLUDED AND ARE ONLY AN EXAMPLE OF INSTALLATION WITHOUT A FLOOR. WHEN USING WOOD FLOOR, THE FLOOR BECOMES YOUR BASE PLATE

STEP 7b:

Nail the 4' x 6' wall panel from the 8' x 8' shed package against wall stud assemblies with 1½" nails. Next nail the 4' x 6' extension panel from this 4' extension kit to the wall stud assembly. If done correctly, the 4' extension panel will overhang the front edge of the top plate by 2". Repeat for the other side.

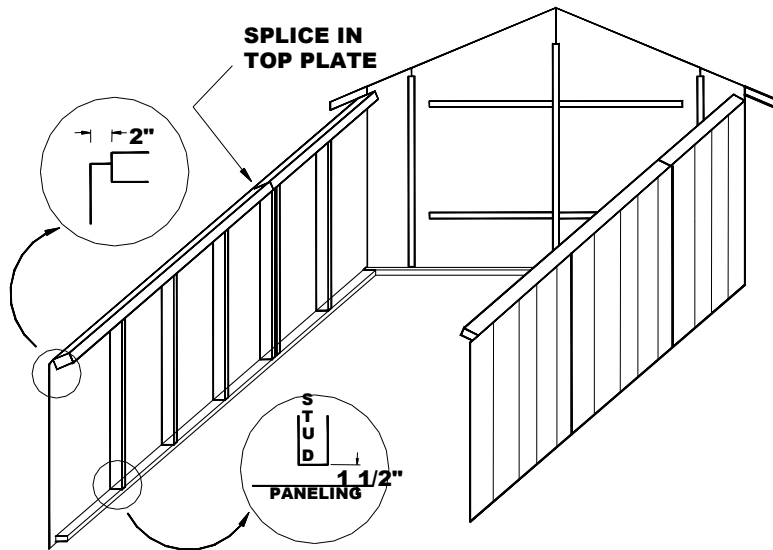

STEP 11b:

Assemble five rafters using the angled plywood gusset plates to produce a proper rafter pitch. Two plywood gusset plates are supplied for each rafter set, to be nailed with 1 ½" nails to both sides of the rafters. Three sets of rafters and gusset plates are found in the 8' x 8' shed package and two sets are found in this extension kit. End rafters do not require gussets, simply nail to the walls.

Note: Rafters must be 106" wide from tail to tail.

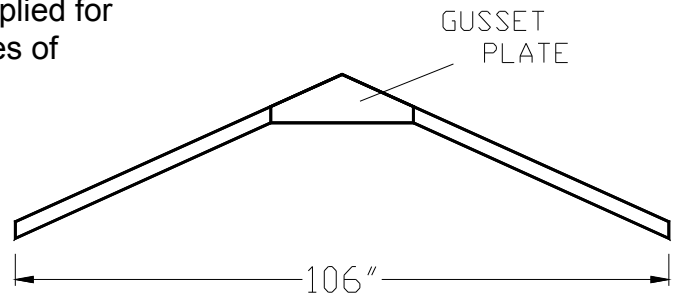

Customer Service Hotline 1-800-465-2918
NORFAB 4' Badger Extension Package

STEP 12b:

Stand the assembled rafters over the side walls, centering them on top of wall studs and nail them in place at 24" on center with 3" nails. Do not install a rafter over the wall stud which is holding the joint between the two wall plates together. It is suggested that you temporarily place a string from the peak of the front and rear fascia boards to help center the rafters over the shed.

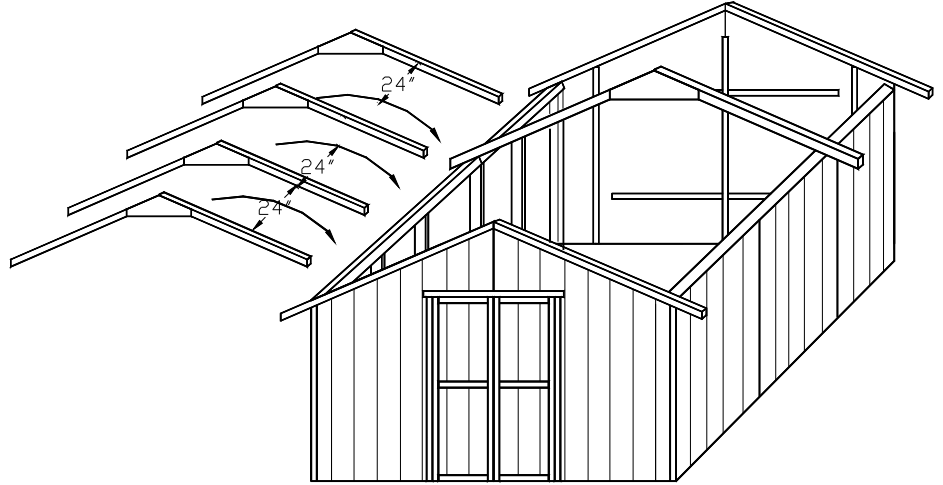

STEP 13b:

Nail the 2" x 3" x 93" fascia boards from the 8' x 8' shed package and the 2" x 3" x 48" fascia boards found in this extension kit in place between the front and rear fascia boards with 3" nails. The 93" long fascia board should be installed in the rear of the shed and the 48" long fascia board installed in the front. Ensure that they are flush with the ends of the front and rear fascia rafters. Nail the fascia boards to the ends of the rafters with 3" nails. In particular, the two fascia boards will join at the end of the second rafter from the front and should be nailed sufficiently.

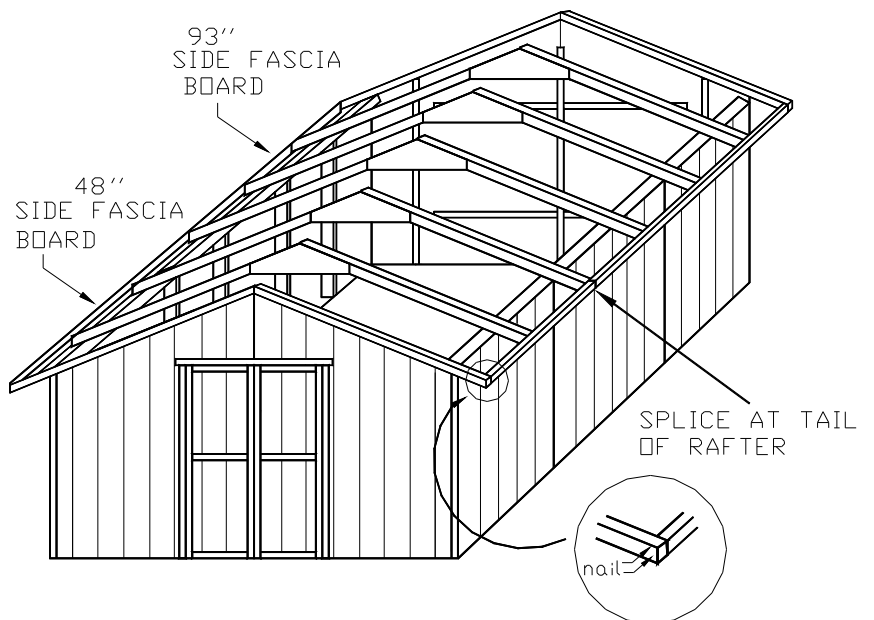

Customer Service Hotline 1-800-465-2918
NORFAB 4' Badger Extension Package

STEP 14b:

Install 4' x 8' roof sheathing from the 8' x 8' shed package so that it is flush with the front and side fascia boards with 1 ½" nails. Next, install the narrow roof sheathing from the 8' x 8' shed package at the peak. Finally, nail the two smaller pieces of roof sheathing found in this extension kit in the rear of the shed. In addition, nail the 5" x 8' plywood soffits from the 8' x 8' shed package and the 5" x 4' plywood soffits from this extension kit underneath the rafters as shown below with the 4' long piece in the front of the shed with the 1 ½" nails provided.

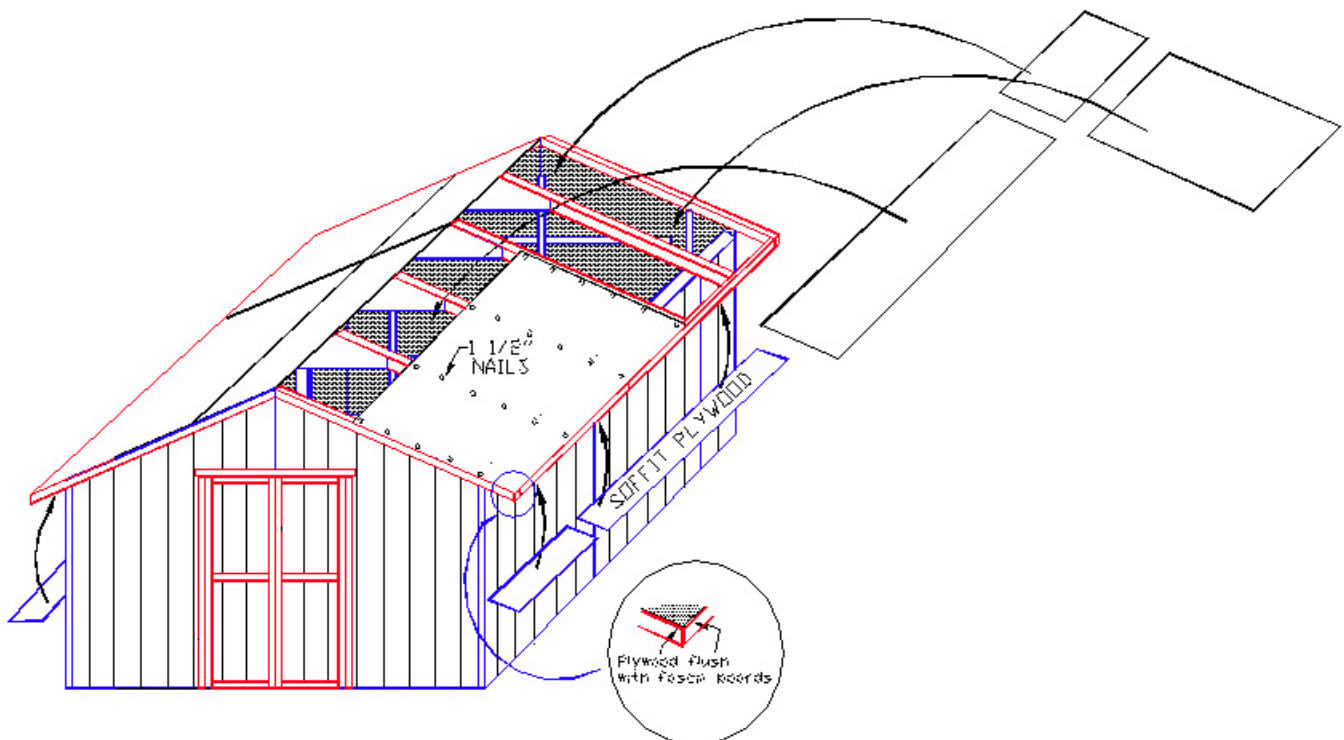

Customer Service Hotline 1-800-465-2918
NORFAB 4' Badger Extension Package